

# Insert Bits

# Slotted Drive

Extra  
Hard

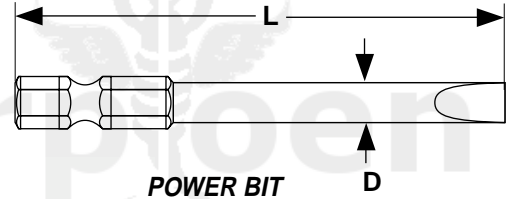
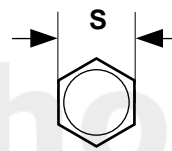
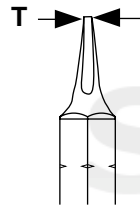
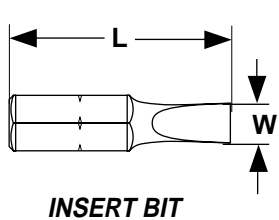

SLOTTED INSERT BITS •E XTRA HARD							Magna™, Apex®*
Part Numbers			Screw Size	S	L	T	W
Kanebridge	Apex®	Magna™		Shank (A.F.)	Overall Length	Blade Thickness	Blade Width
27-001	445-2-15	27001	6 - 8	1/4	1-1/2	.040	.250
27-002	445-3-15	27002	8 - 10	1/4	1-1/2	.042	.281
27-003	445-4-15	27003	10 - 12	1/4	1-1/2	.046	.281
39-534	445-10	39534	4 - 5	1/4	1	.034	.187
39-535	445-20	39535	5 - 6	1/4	1	.036	.218
39-536	445-2	39536	6 - 8	1/4	1	.040	.250
39-537	445-3	39537	8 - 10	1/4	1	.042	.281
39-538	445-4	39538	10 - 12	1/4	1	.046	.281
39-539	-	39539	12 - 14	1/4	1	.050	.281
41-175	-	41175	0 - 1	1/4	1	.024	.109
41-176	445-000	41176	1 - 2	1/4	1	.026	.125
41-177	445-00	41177	2 - 3	1/4	1	.028	.140
41-178	445-0	41178	3 - 4	1/4	1	.032	.156

SLOTTED POWER BITS •E XTRA HARD							Magna™, Apex®*
Part Numbers			Screw Size	S	L	T	D
Kanebridge	Apex®	Magna™		Shank (A.F.)	Overall Length	Blade Thickness	Body Diameter
27-461	320-00	27461	2 - 3	1/4	1-15/16	.028	.134
27-462	320-0	27462	3 - 4	1/4	1-15/16	.032	.154
27-463	320-1	27463	4 - 5	1/4	1-15/16	.034	.187
27-464	320-2	27464	5 - 6	1/4	1-15/16	.036	.215
27-465	320-3	27465	6 - 7	1/4	1-15/16	.038	.250
27-466	320-4	27466	8 - 10	1/4	1-15/16	.042	.275
27-467	320-5	27467	10 - 12	1/4	1-15/16	.046	.312
27-468	320-6	27468	12 - 14	1/4	1-15/16	.050	.360

\*Bits meet the same dimensions as those published by the manufacturers of the Apex® and Magna™ brands.

<b>Applications/Advantages</b>	Slotted bits require less downward pressure to drive parts than those with cross-recessed openings. It is important to choose the proper fitting blade to minimize slippage. Power bits are for use with power drivers. Insert bits are used with hand drivers, or may be used in power drivers when inserted into a bit holder. Extra hard bits are used specifically with case hardened screws.
<b>Material</b>	Chrome vanadium tool steel
<b>Hardness</b>	Rockwell C 59 - 62.

®Apex is a registered trademark of Cooper Industries.

™Magna is a division of Vermont American Corporation.

Kanebridge's insert and power bits are not manufactured by or connected with the producers of Apex® and Magna™ bits.