

# NUTS

## HEX FLANGE No Serrations

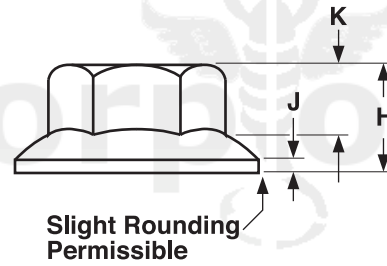
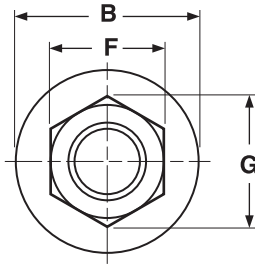

| HEX FLANGE NUTS                                |        |                    |       |                      |       |                 |       |               |       |                  |                  | ASME B18.2.2-2010 |
|--|--------|--------------------|-------|----------------------|-------|-----------------|-------|---------------|-------|------------------|------------------|-------------------|
| Nominal Size or Basic Major Diameter of Thread |        | F                  |       | G                    |       | B               |       | H             |       | K                | J                |                   |
|  |        | Width Across Flats |       | Width Across Corners |       | Flange Diameter |       | Nut Thickness |       | Wrenching Height | Flange Thickness |                   |
|  |        | Max                | Min   | Max                  | Min   | Max             | Min   | Max           | Min   | Min              | Min              |                   |
| 8  | 0.1640 | 0.344              | 0.334 | 0.397                | 0.381 | 0.469           | 0.452 | 0.203         | 0.187 | 0.13             | 0.02             |                   |
| 10   | 0.1900 | 0.375              | 0.365 | 0.433                | 0.416 | 0.500           | 0.480 | 0.219         | 0.203 | 0.13             | 0.03             |                   |
| 1/4  | 0.2500 | 0.438              | 0.428 | 0.505                | 0.488 | 0.594           | 0.574 | 0.236         | 0.222 | 0.14             | 0.04             |                   |
| 5/16   | 0.3125 | 0.500              | 0.489 | 0.577                | 0.557 | 0.680           | 0.660 | 0.283         | 0.268 | 0.17             | 0.04             |                   |
| 3/8  | 0.3750 | 0.562              | 0.551 | 0.650                | 0.628 | 0.750           | 0.728 | 0.347         | 0.330 | 0.23             | 0.04             |                   |
| 7/16   | 0.4375 | 0.688              | 0.675 | 0.794                | 0.768 | 0.937           | 0.910 | 0.395         | 0.375 | 0.26             | 0.04             |                   |
| 1/2  | 0.5000 | 0.750              | 0.736 | 0.866                | 0.840 | 1.031           | 1.000 | 0.458         | 0.437 | 0.31             | 0.05             |                   |
| 9/16   | 0.5625 | 0.875              | 0.861 | 1.010                | 0.982 | 1.188           | 1.155 | 0.506         | 0.483 | 0.35             | 0.05             |                   |
| 5/8  | 0.6250 | 0.938              | 0.922 | 1.083                | 1.051 | 1.281           | 1.248 | 0.569         | 0.545 | 0.40             | 0.05             |                   |
| 3/4  | 0.7500 | 1.125              | 1.088 | 1.299                | 1.240 | 1.500           | 1.460 | 0.675         | 0.627 | 0.46             | 0.06             |                   |

|                                 |  |
|---------------------------------|--|
| <b>Description</b>              | Hex nut with an enlarged circular base flaring out from the bottom of the nut. The bearing surface of the flange is smooth, with no serrations.  |
| <b>Applications/ Advantages</b> | Will span oversized or poorly aligned holes. Flange provides a more uniform bearing-stress to clamp-force ratio than other low carbon nuts. Does not gall screw threads.   |
| <b>Material</b>                 | <i>Steel</i><br>Nuts shall be made from a carbon steel which conforms to the following chemical composition requirements--<br><u>Low Carbon:</u> <b>Carbon:</b> 0.47% max.; <b>Phosphorus:</b> 0.12% max.; <b>Sulfur:</b> 0.23% max.<br><u>Grade-5 Nuts:</u> <b>Carbon:</b> 0.55% max.; <b>Manganese:</b> 0.30% min.; <b>Phosphorus:</b> 0.05% max.; <b>Sulfur:</b> 0.15% max. |
| <b>Hardness</b>                 | <u>Low Carbon:</u> Rockwell B68 - C32<br><u>Grade-5 Nuts:</u> Rockwell C32 max.  |
| <b>Plating</b>                  | See Appendix-A for plating information.  |